

RESIDENTIAL SLIDES - GEL COAT:

The **BYOS** slides are **CUSTOM** slides and cannot be ordered without going through the quote and design process at Inter-Fab. 800-737-5386

The Build Your Own Slide™ (BYOS™) provides easy slide solutions to builders incorporating handcrafted rock work or concrete formations into custom backyard settings.



FEATURES:

- A Collection of 10 Different Flume Sections That Can Be Used in Various Combinations
- Exclusive Zoom Flume™ Water Delivery System
- Construction Anchoring System Included
- Stainless Steel Hardware Included
- Optional Handrails Available
- Variety of Earth Tones & Gray Colors Available
- Advanced High-Tech RTM Manufacturing
- Weight Limit = 250 lbs.
- Multiple Patents Pending

BYOS STANDARD COLORS:

Tan: -51;
 Gray: -52;
 Summit Gray: -.53;

BYOS CUSTOM COLORS:

Mont Blanc: -54;
 Pebble: -55;
 Fashion Gray: -56
 Cappuccino: -57

(add custom color code behind part #)



BYOS™ (BUILD YOUR OWN SLIDE):

The **BYOS** slides are **CUSTOM** slides and cannot be ordered without going through the quote and design process at Inter-Fab. 800-737-5386

Part	Length (Centerline)
1	31.00"
2	19.50"
3	30.00"
4	19.50"
5	12.25"
6	22.00"
7	60.00"
8	22.00"
9	12.25"
10	36.00"

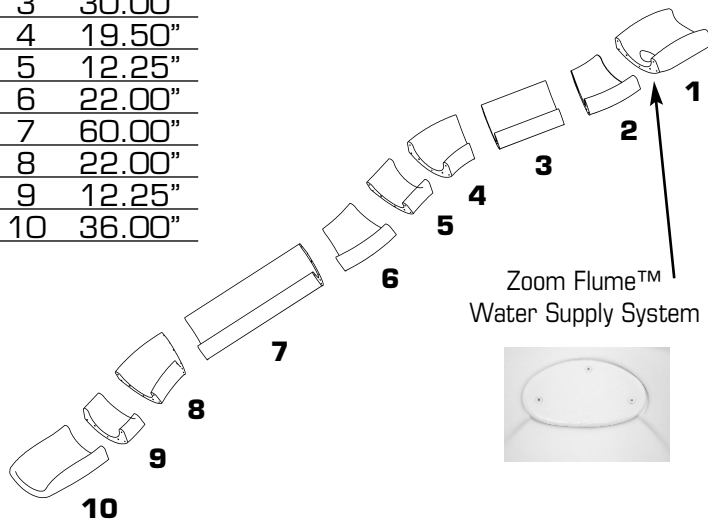

FEATURES:

- A Collection of 10 Different Flume Sections That Can Be Used in Various Combinations
- Exclusive Zoom Flume™ Water Delivery System
- Construction Anchoring System Included
- Stainless Steel Hardware Included
- Optional Handrails Available
- Variety of Earth Tones & Gray Colors Available
- Advanced High-Tech RTM Manufacturing
- Weight Limit = 250 lbs.
- Multiple Patents Pending

BYOS STANDARD COLORS:

Tan: -51;
 Gray: -52;
 Summit Gray: -.53;

BYOS CUSTOM COLORS:

Mont Blanc: -54;
 Pebble: -55;
 Fashion Gray: -56
 Cappuccino: -57

(add custom color code behind part #)

10 PIECES TO CHOOSE FROM:

1. Entry Section with built in 15° down slope and Zoom Flume™ water delivery system
2. Right Turn 15° Slope Section (3' radius)
3. 2.5' Straight Section
4. Left Turn 15° Slope Section (3' radius)
5. 15° Down Wedge
6. Right Turn 30° Slope Section (3' radius)
7. 5.0' Straight Section
8. Left Turn 30° Slope Section (3' radius)
9. 15° Up Wedge
10. Exit Section with built in 15° up slope

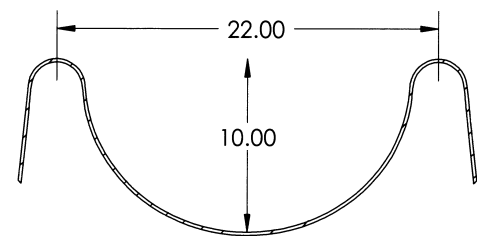
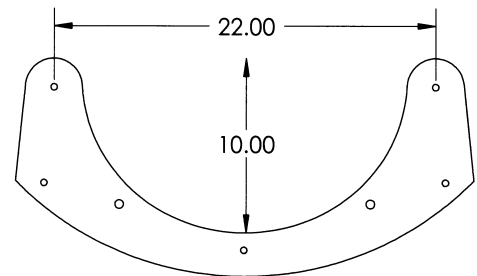
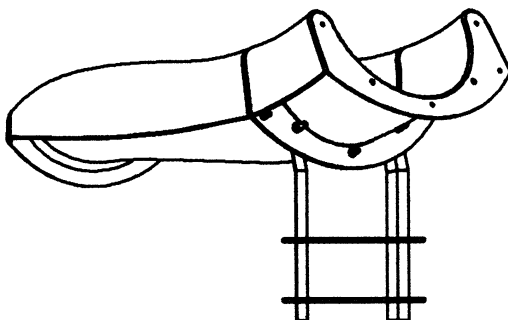

BYOS™ (BUILD YOUR OWN SLIDE):

The BYOS slides are CUSTOM slides and cannot be ordered without going through the quote and design process at Inter-Fab. 800-737-5386

THE OPTIONAL ASSIST RAILS

SEATING ASSIST RAIL:

Entry section handrails are available in both surface mount with 3.5" flange (3 bolts) or sub-surface mount versions.

Surface Mount 3.5" Flange:

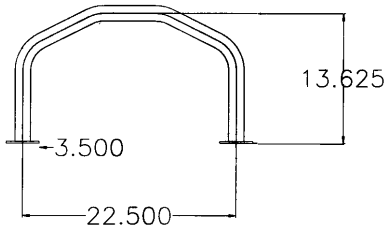

Sub-Surface Mount:

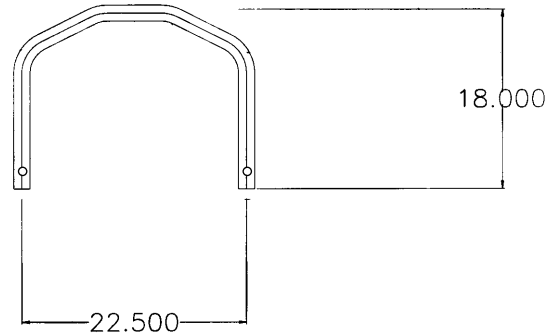

CLIMBING ASSIST RAIL:

Climbing assist rails are available in both surface mount (3.5" flange) or sub-surface mount versions. Climbing assist rails are available in standard 24", 36" and 48" lengths. Custom rails are available.

Surface Mount 3.5" Flange:

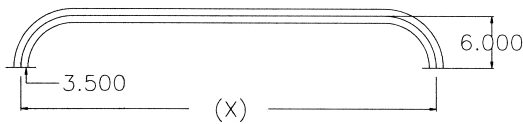

Sub-Surface Mount:

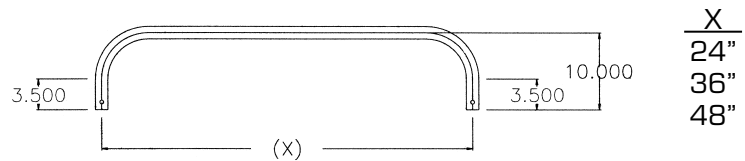

C. ANCHOR/SUPPORT SYSTEM

The Construction Anchoring/Support System is comprised of: seating section support that will be placed into concrete pier of 12" long x 36" wide x 24" deep (contractor provided), or minimum 24" diameter tube. The vertical 15° and 30° anchors will attach to connection points specified during our design process, and are placed into concrete piers that are 12" long x 24" wide x 24" deep (contractor provided), or minimum 24" diameter tube. The anchor/supports are powder coated black at the factory for protection. Determination of the quantity and placement of the anchors will be done within the CAD process.



Seating Support
Anchor



Seating Support
Anchor Support Arms

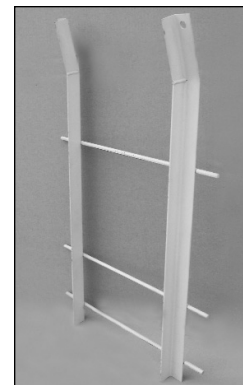

15° Support
Anchor

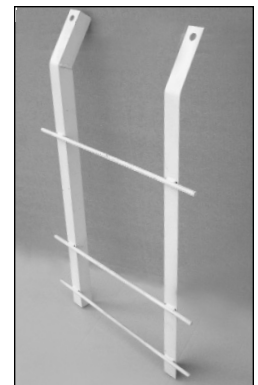

30° Support
Anchor